



PORTABLE SHOWCASE

KEITA "Catering" Case

ケイタ "ケータリング" ケース / KEITA "便携式" 系列

MODEL Name

KEITA - 6M

Design Type
Unit Width (in feet, C = custom size)
Remote Non-Refrigerated Unit

- **Rectangular Profile - easy to setup**
縦断面は長四角で簡単セットアップ / 矩形抛面设计
- **Stainless Steel Body - durable and long lasting**
丈夫で耐久性のあるステンレス素材 / 不锈钢柜体
- **Easy to Transport - no electricity needed**
コンセント無しで簡単移動 / 方便移动
- **Fully Visible Foodzone - Better exhibition**
フードゾーンが良く見え、より良い陳列ができる / 全透明的食品展示区
- **1.5" Deep Ice Pan Floor - convenient for ice storage**
底が1.5インチと深く、氷の保存に便利 / 1.5英寸深的可存冰的底板
- **1" Thick Insulated Sides - keeps foodzone temperature low**
1インチ厚のフードゾーンの温度を低く保てる / 直径为一英寸的排水管
- **Large Water Drain - 1" diameter for easier and faster cleaning**
直径1インチの大きな排水口で簡単、迅速なお手入れ / 直径为一英寸的排水管
- **Heavy-Duty Clear Plexiglas Doors - safer operation**
透明な強化プレキシガラスドアで安全操作 / 耐用的透明的有机玻璃门
- **LED Light - optional**
LEDライトはオプションです / LED 光源 - 选择事项

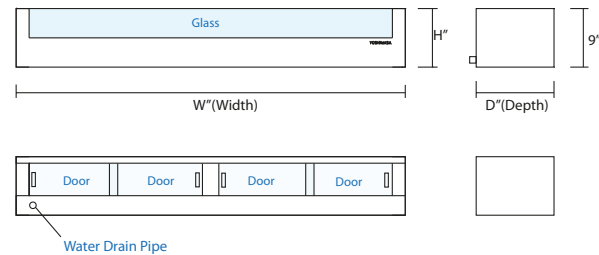
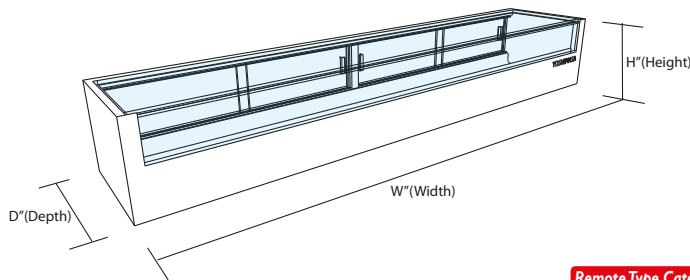
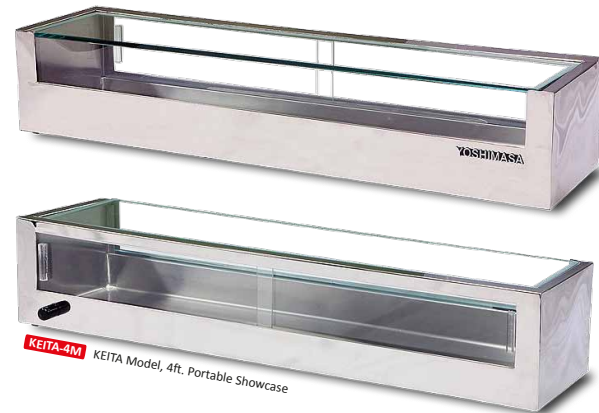
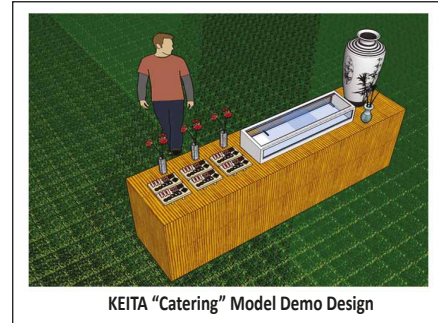

Remote Type Catering Case

Warranty

1 Year Limited Warranty

(for Remote Non-Refrigerated Unit - On limited Part only)

Model	Dimensions Exterior(WXDxH)	Net Weight	Materials Exterior/Interior/Insulation	Back Doors	Floor Mat	Viny Hose w/ Clamp	Thermo- meter	Drain Cap
KEITA-3M	36" X 12" X 9"	56 lbs	304 Stainless Steel(Mirro Polished) Plexi Glass Polyurethane Foam	2 pcs	N/A	1 set	N/A	1 ea
KEITA-4M	48" X 12" X 9"	64 lbs		2 pcs				
KEITA-5M	60" X 12" X 9"	72 lbs		4 pcs				
KEITA-6M	72" X 12" X 9"	83 lbs		4 pcs				
KEITA-7M	84" X 12" X 9"	97 lbs		4 pcs				
KEITA-CM*	Custom Size	-		-				

* CM = Custom Size

Sushi Display cases are not for overnight storage.

YOSHIMASA reserves the right to change specifications without prior notice.

