



REMOTE SUSHI DISPLAY CASE

SHIKAKU "In-Table" Model

四角"テーブル"モデル/SHIKAKU "内嵌式"系列

MODEL Name

SHIKAKU - 6M

Design Type
Unit Width (in feet, C = custom size)
Remote Non-Refrigerated Unit

○ **In-Table Use Sushi Case**

テーブルでの寿司ネタケース使用 / 内嵌式的寿司展示柜

○ **Sliding Top Doors - beneficial to sushi chefs**

上部の引き戸は寿司シェフにとってとても便利 / 上部滑动门

○ **Stainless Steel Body - durable and long lasting**

丈夫で耐久性のあるステンレス素材 / 不锈钢柜体

○ **8" Deep Under Table Top - perfect for tall sushi bars**

テーブルより8インチ下がつて寿司バーには最適のデザイン / 伸入桌面八英寸深

○ **Large Water Drain - 1" diameter for easier and faster cleaning**

テーブルより8インチ下がつて寿司バーには最適のデザイン / 直径为一英寸的排水管

○ **Heavy-Duty Clear Plexiglas Doors - safer operation**

透明の丈夫なプレキシガラスドアで安全操作 / 耐用的透明的有机玻璃门

○ **Various Customizable Options - available upon request**

ご希望によりいろいろな形にカスタム注文できます / 可定制任何不同外观

○ **Bamboo Floor Mat - Included**

竹マット込み / 竹制底垫

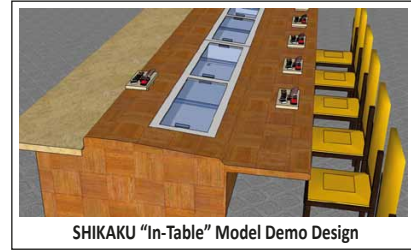

SHIKAKU "In-Table" Model Demo Design

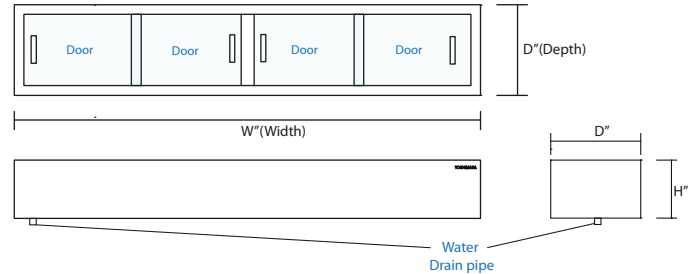
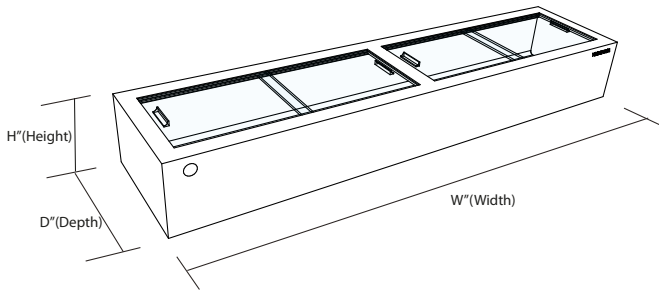
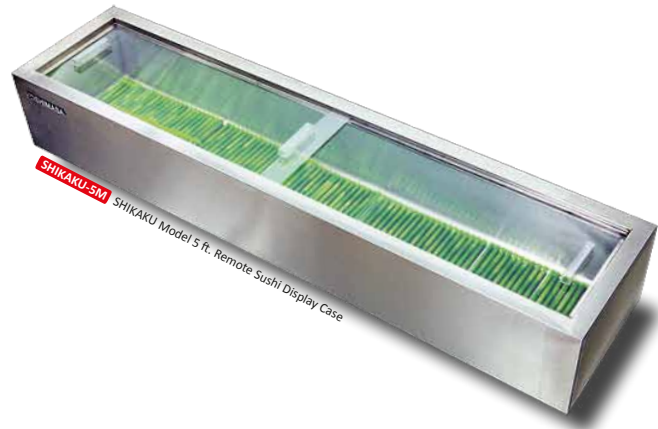

Remote Type Sushi Display Case

SHIKAKU MODEL

Warranty

1 Year Limited Warranty

(for Remote Non-Refrigerated Unit -On limited Part only)

Model	Dimensions Exterior(WXDxH)	Net Weight	Materials Exterior/Interior/Insulation	Back Doors	Floor Mat	Viny Hose w/ Clamp	Thermo- meter	Drain Cap
SHIKAKU-3M	36" X 14" X 9"	47 lbs	304 Stainless Steel Plexiglass Polyurethane Foam	2 pcs	1 set	1 set	1 ea	1 ea
SHIKAKU-4M	48" X 14" X 9"	57 lbs		2 pcs				
SHIKAKU-5M	60" X 14" X 9"	66 lbs		2 pcs				
SHIKAKU-6M	72" X 14" X 9"	77 lbs		4 pcs				
SHIKAKU-7M	84" X 14" X 9"	88 lbs		4 pcs				
SHIKAKU-CM*	Custom Size	-		-				

* CM = Custom Size

Sushi Display cases are not for overnight storage.
YOSHIMASA reserves the right to change specifications without prior notice.

